



Islingword Road

, Brighton BN2 9SE

- AVAILABLE MAY 2ND!
 - First Floor Flat
 - Long Term
 - Newly Refurbished
- Two Double Bedrooms
 - Furniture Optional
 - Great Location
 - Students Welcome

£1,750 PCM

Local Authority Brighton and Hove City Council
Council Tax Band A
EPC Rating D

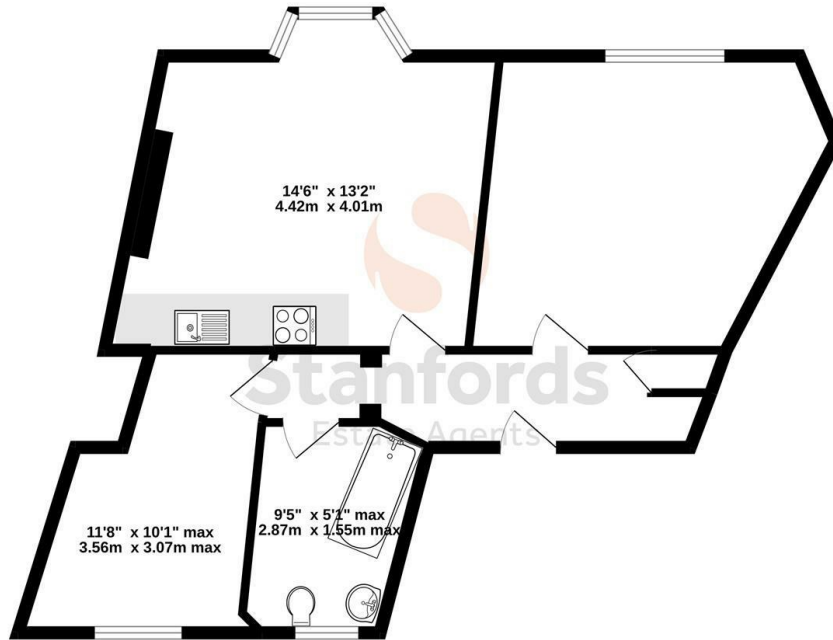

TOTAL FLOOR AREA: 783 sq.ft. (72.7 sq.m.) approx.
Whilst every attempt has been made to ensure the accuracy of the floorplan contained here, measurements of doors, windows, rooms and any other items are approximate and no responsibility is taken for any error, omission or mis-statement. This plan is for illustrative purposes only and should be used as such by any prospective purchaser. The services, systems and appliances shown have not been tested and no guarantee as to their operability or efficiency can be given.
Made with Metropix ©2022



Moretons Lettings Office
30-31 North Street, Brighton,
East Sussex, BN1 1EB

Contact

Agents Note: Whilst every care has been taken to prepare these particulars, they are for guidance purposes only. All measurements are approximate and for general guidance purposes only and whilst every care has been taken to ensure accuracy, they should not be relied upon and potential buyers/tenants are advised to recheck the measurements.