



## Market Street

, Brighton BN1 1HH

- Three double bedroom maisonette
- Large living room overlooking the South lanes
  - Separate W/C
  - Neutral décor throughout
  - Available now
- Separate kitchen with all appliances
- Close To Brighton Mainline Station
- Modern bathroom with separate bath and shower
- Amazing Location
- VIDEO LINK

**£2,300 PCM**

**Local Authority Brighton & Hove City Council  
Council Tax Band B  
EPC Rating E**

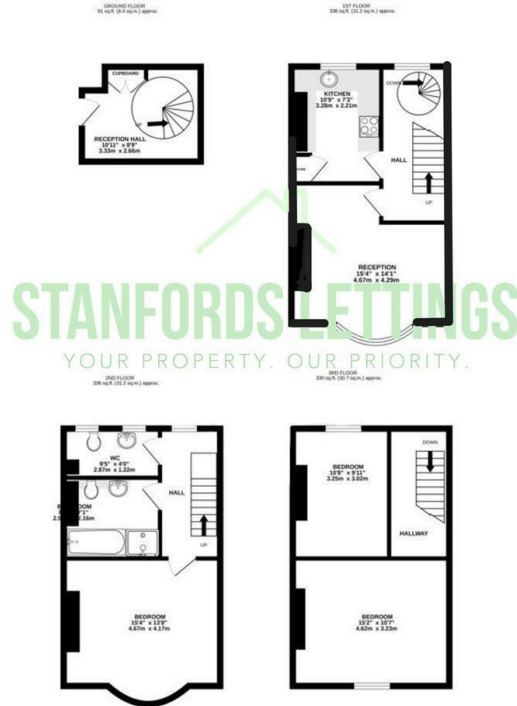

TOTAL FLOOR AREA: 1093 sq ft (101.6 sq m.) approx.  
Whilst every attempt has been made to ensure the accuracy of the floorplan contained here, measurements of doors, windows, rooms and any other items are approximate and no responsibility is taken for any error, omission or mis-statement. This plan is for illustrative purposes only and should be used as such by any prospective purchaser. The services, systems and appliances shown have not been tested and no guarantee as to their operability or efficiency can be given.  
Made with Metropix ©2022



**Stanfords Lettings Office**  
30-31 North Street, Brighton,  
East Sussex, BN1 1EB

**Contact**  
01273 733334  
lettings@stanfords-  
estates.com  
www.stanfords-estates.com

Agents Note: Whilst every care has been taken to prepare these particulars, they are for guidance purposes only. All measurements are approximate and for general guidance purposes only and whilst every care has been taken to ensure accuracy, they should not be relied upon and potential buyers/tenants are advised to recheck the measurements.